

Philip Webb Award 2018 - Notes for Entrants

An annual award from the SPAB for recent graduates and Part II students at UK Schools of Architecture

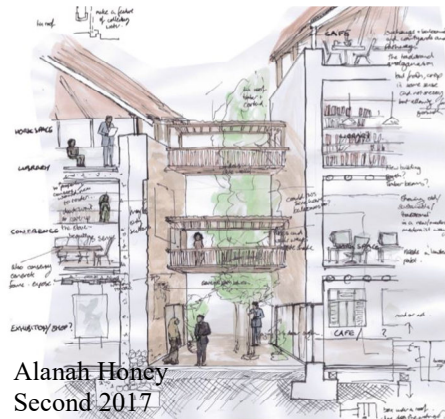

Marta Ascenso
Winner 2017



Alanah Honey
Second 2017



Kate Nicholson
Third 2017

The SPAB and Philip Webb

Architect Philip Webb and designer, author and craftsman William Morris were the principal founders of the SPAB in 1877. The Society campaigned for the sensitive care and maintenance of old buildings using traditional materials and skills, and set out its distinctive philosophy of 'conservative repair' in a *Manifesto*, which still guides its work today. From the start, Webb devoted time to encouraging young architects to understand old buildings and appreciate their value, and to teaching them the principles and methods of practical conservation.

The SPAB maintains that educational role today, for example through its Scholarship programme for early-career architects, surveyors and engineers. This Award, named in honour of Webb, is presented annually.

The Competition

Judged by an expert architectural panel, the Philip Webb Award is a design-orientated competition encouraging sympathetic reuse of existing buildings and sensitive new design in an historic context.

It is a unique opportunity for students and architects in the early stages of their career who are interested in sustainability, reuse of old buildings and conservation practice to engage with the SPAB's principles and showcase their skills.

The Brief

To devise a scheme which sympathetically revitalises a historic building of the entrant's choosing, which has decayed or been neglected, but which can be repaired and adapted for a sympathetic new use.

The scheme should incorporate both careful repair of existing fabric and a significant element of new construction in a contemporary design.

The scheme submitted might be a piece of work carried out as part of Part II course work or a project devised specifically for this competition.

Prizes

1st prize £1000 2nd prize £500 3rd prize £100

The SPAB will publicise competition entries, including on its website and in its quarterly Magazine.

Eligibility

The competition is open to:

- All students at UK Schools of Architecture who have achieved RIBA Part I and are currently working towards RIBA Part II.
- Recent Part II graduates who completed their studies in 2016 or 2017.
- Entrants may submit work singly or as part of a team, though in that event any prize money awarded will be shared.

Competition dates

Submission of entries to the competition:

Opens 20 July 2018

Closes 14 September 2018 at 5pm

Entries received outside the submission period will not be considered.

Judges

The competition will be judged by an expert panel comprising:

Kate Darby - architect, whose Croft Lodge Studio (with David Connor) won AJ's Small Project Award 2017.

Izaak Hudson - of dittrich, hudson, vasetti & conservation architect to Truro, Salisbury & Llandaff Cathedrals.

Roger Hunt - architectural writer & co-author of the RIBA / SPAB book *New Design for Old Buildings* (2017).

Judging criteria

The judges will be looking for:

- A sensitive historical and architectural appraisal of the existing building(s) through research, investigation, measured drawings etc.
- A clear presentation and reasoned explanation of the steps to be taken to conserve and repair existing fabric, demonstrating understanding of repair techniques and materials.
- A convincing statement of the design approach taken to the contemporary interventions proposed to enable the building's reuse.
- Evidence showing how the scheme responds to the SPAB's principles and a clear illustration of how the relationship between the old and the new is managed.
- High standards of presentation in drawings and written material.

The results of the competition will be announced in autumn 2018.

All entrants should refer to the guide to the SPAB's Approach to old buildings, available at:

<https://www.spab.org.uk/campaigning/spab-approach>

Submitting an entry

Each entrant (or team of entrants) is asked to submit the following:

- 2x A1-size drawings (mounted on card or lightweight board) illustrating the proposal
- Copies of these drawings as digital images (by email / file transfer / disc / USB)
- A concise report setting out details of the scheme, including a location plan, survey drawings, photographs and contextual information, and explaining how you approached the project, with reference to the SPAB's principles. (printed copy + electronic copy - as above)
- A completed entry form - available to download from <https://www.spab.org.uk/about-us/awards/philip-webb-award> or by email from education@spab.org.uk
- An "executive summary" capturing the scheme's key points and the entrant's aims and approach to it. This should be no more than 400 words in length.

Entrants should ensure their name is clearly marked on the **reverse** (not the face) of any drawings, reports or documents submitted. Please do not include your name or other identifying details within the text of reports or in drawing annotations.

Entries can be submitted by post to Philip Webb Award, SPAB, 37 Spital Square, London, E1 6DY.

Digital images should be included with postal submissions on a memory stick/disc, sent by file transfer, or emailed separately to: education@spab.org.uk

The **closing date** for receipt is **5pm on 14 September 2018**

Entries received after this will not be considered.

Entries that are incomplete or not presented in the specified format will not be considered.

What happens next?

Entries will be assessed anonymously against the published criteria and a shortlist drawn up.

Shortlisted entrants will be notified by **5 October 2018** and invited to present their scheme to the judges in person at an **assessment day** to be held at the SPAB's HQ on **15 November 2018**. Each entrant on the shortlist will have 20 minutes in which to set out their scheme and discuss it with the judges.

Entrants will be notified of the outcome of the competition as soon as possible after the assessment day.

Prizes will be presented at an SPAB event in 2019.

Please note

Do not submit framed drawings, loose photographs or architectural models (though photographs illustrating models are acceptable). The SPAB accepts no liability for loss or damage to submitted items and entrants are advised to retain copies of all their material.

The SPAB will retain winning submissions. After the competition, material not required for retention by SPAB should be collected from SPAB's offices by **Monday 11 February 2019**.